



Lot 2 Womma Road, **Edinburgh**

\$320,000

Prime Industrial Parcel Womma Road Frontage

3153sqm of prime industrial land Gateway opportunity to industry B Double access A blank canvas to design your own building to run your business, or build an investment to rent out. Rub shoulders with the big boys. Enquire today!



Elizabeth West

MAKE YOUR BUSINESS A PRIORITY!

**Selling 7 Lots **Individually or together **Zoned Industrial **Prime Location **Networking Opportunity
**Mix with Success! **For more information please call Colin Today on 0412 822 166.



Lot 52 Ridgeway Road, **Elizabeth West**

Excellent Location!

**3.72 acres approx (1.50ha) **Zoned Industry **Fabulous opportunity set in Industrial Hub **Opportunity to re-subdivide (stcc)



211 & 212 (95) Womma Road, **Elizabeth West**

Industrial, Engineering, Manufacturing Factory With Leaseback 5 + 5 + 5

Stable lease agreement with company with 35 years of history. Current site known as an Innovation Network, placed on approx 48,160sqm with manufacturing factory (9396sqm approx) with 15, 20 & 30 tonne cranes, heavy industry in operation, office space (1875sqm approx) including offices, board rooms, meeting rooms, lunch room, hard standing storage yards & plenty of car parking. Offering a return of approx \$1,099,000pa) with current leases in place with national companies, (potential for \$1,250,000) company currently employs over 120 people with national & international contracts. This...



Lot 45 46 & 47 Gawler River Road, **Lewiston**

Auction

FABULOUS MARKET GARDEN OPPORTUNITY

Set on 57.6 acres = 23.312 Hectares. 3 Titles: Lot 45 = 8.093 Hectares Lot 46 = 8.093 Hectares Lot 47 = 7.126 Hectares 20 million gallons of bolivar water 12 million gallons of boar water Power connected 3 Large implement sheds Great soil for vidualture! 2 Rear frontages - Gawler River Road & Johns Road Bituman frontage! Close to Virginia, Gawler and amenities. We will offer as a whole or sell separately!



9 Dakota Drive, Parafield Airport

\$52,250 + gst per annum

PROFESSIONAL SUITES

**Upstairs facilities of approx 226.6sqm **Reception **Boardroom **6 Offices **Kitchen **Plenty of Parking **High Exposure location!! (5+5 lease term / tenants cover all outgoings) For More Information call Colin Martin 0412 822 166



Salisbury East

Ideal Existing Facility!

This property is ideal for **Church **Child Minding Facility **Medical Centre ** Funeral Parlour (subject to council approval) Huge facilities : Top Quality 60 carparks and perfectly located. VENDOR FINANCE AVAILABLE APPROVED APPLICANT ONLY! For more information please ring John Martin 0412 856 395 View only by appointment and Price on Application.



Lot 26 Industry Drive, Whyalla

SET YOUR COMPANY UP!

Set Your Company Up, Ready For The Mining Expansion! * Owner will consider purpose build - negotiable. * High Exposure * 2328sqm (approx) of Industrial Land * Fully serviced * Set up next to the "Big Boys" including CavPower & OneSteel Whyalla Priced To Sell Lease Opportunity also available! For More Information Call John Martin 0412 856 395

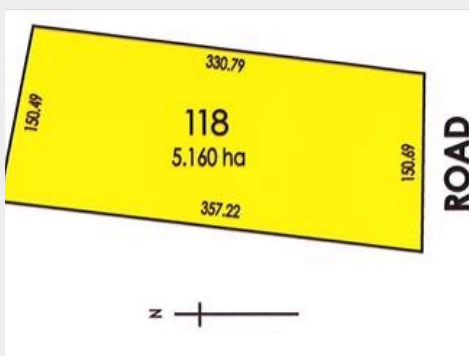

Lot 118 McIntyre Road, Whyalla

Set Up Your Business Here

Re-subdivide opportunity subject to council consents Set in SA's largest industrial estate 51,600sqm Gateway to Roxby Downs Next to the largest open cut mine in the world. For more information call John Martin on 0412 856 395



Lot 3000 Jenkins Avenue, Whyalla Jenkins

\$3,500,000.00

APPROVED LIFESTYLE RETIREMENT VILLAGE SITE

3.661 Hectares with approval for 83 Units and Community Centre and a further site of 2.27 hectares for future development. The FIRST of it's Kind in Whyalla! Outstanding Opportunity to develop a lifestyle village within the Ocean Eyre master planned estate. Ideally positioned close to shops, transport, proposed child care centre and proposed retail centre. * Ocean Eyre a master planned estate in the heart of the Upper Spencer Gulf * Designed by McLoughlin Architects to comply with the Retirement Villages Act. * Price includes Area of 3.61 hectares (area marked "A") and...



36-38 Park Terrace, **Salisbury**

Auction

Ripe for Re-Development (stcc)

High exposure Fantastic location Rub shoulders with McDonalds, KFC & Benson Radiology Get in early, exciting times ahead for Salisbury Re-Development! Close to transport, train, bus & Salisbury town centre Traffic volume approx 33,300 cars per day It's got it all How good would your business look on this location! Auctioned to sell on the 20th of April on-site at 1pm



36-38 Park Terrace, **Salisbury**

Auction

Ripe for Re-Development (stcc)

High exposure Fantastic location Rub shoulders with McDonalds, KFC & Benson Radiology Get in early, exciting times ahead for Salisbury Re-Development! Close to transport, train, bus & Salisbury town centre Traffic volume approx 33,300 cars per day It's got it all How good would your business look on this location! Auctioned to sell on the 20th of April on-site at 1pm